

# WILL TOWNSHIP ELECTION PRECINCTS

TOWNSHIP 33 N -- RANGE 13 E

1"=1,200'



**NANCY SCHULTZ VOOTS**  
WILL COUNTY CLERK

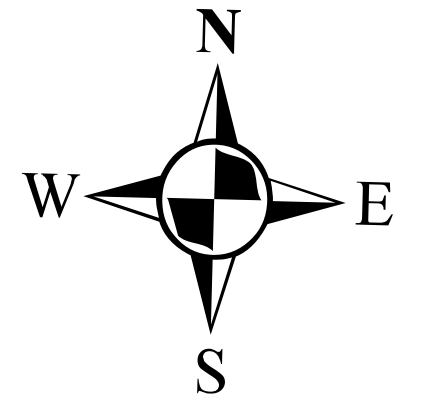
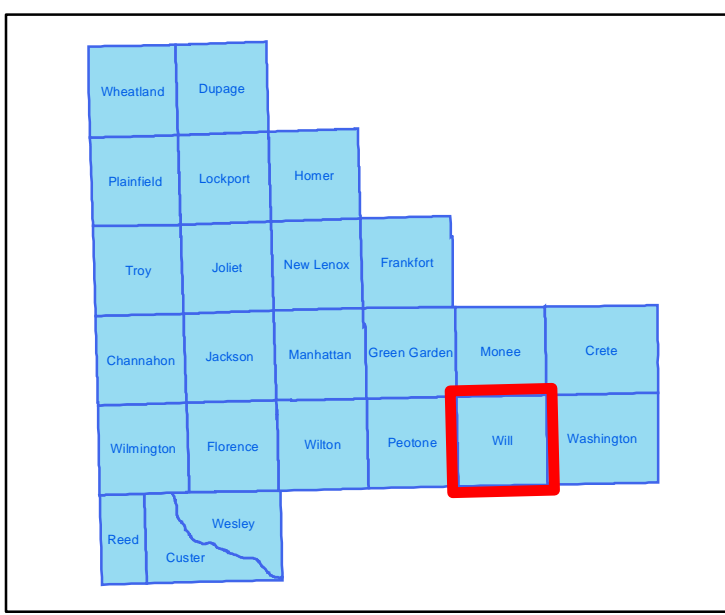

**PRECINCT**      **POLLING PLACE**

Will 1      Bull Field  
28261 S. Kedzie Ave., Monee

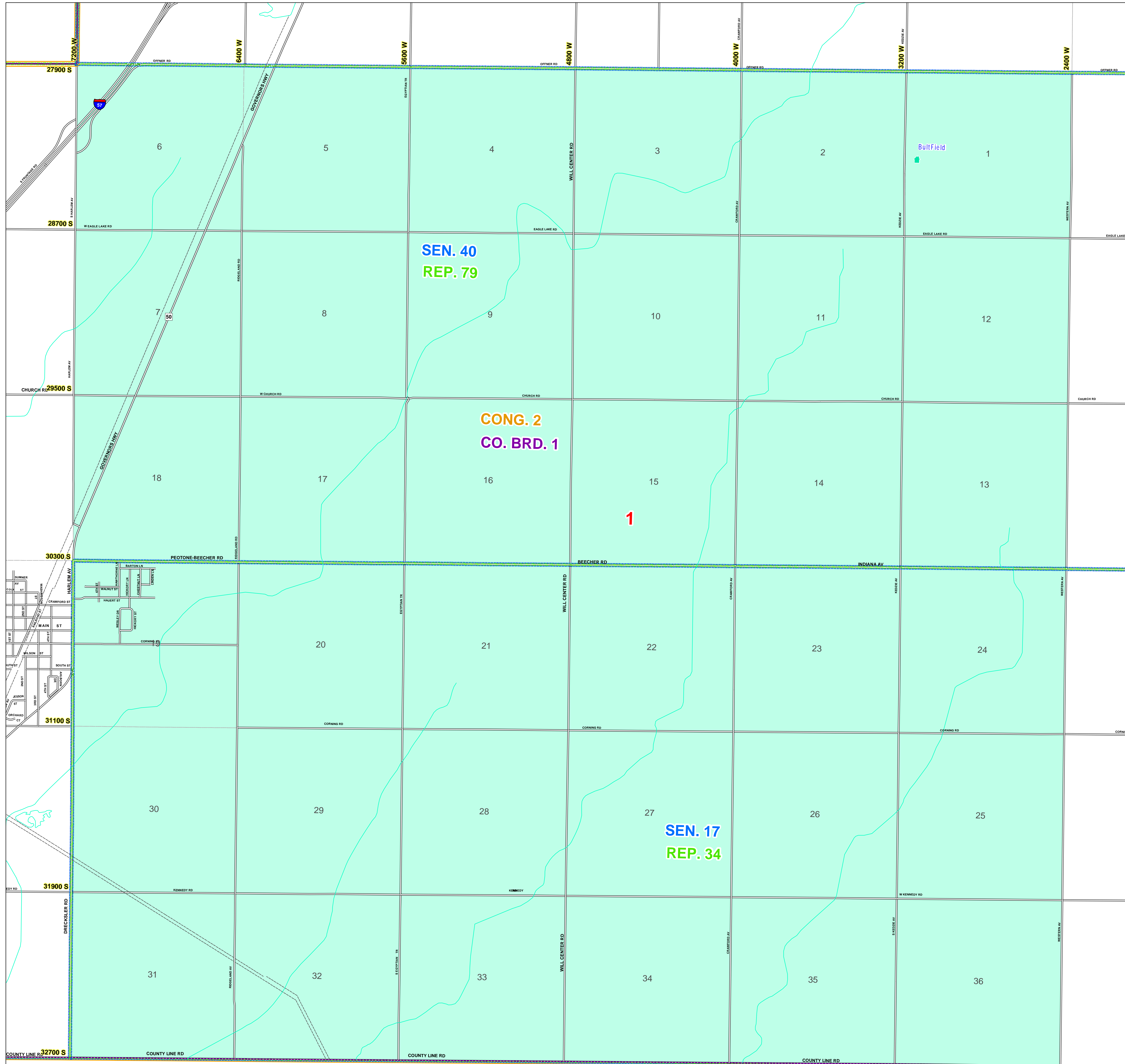

- State Senate
- County Board
- Congressional
- State House

PLOT DATE: Friday, July 06, 2012  
PREPARED BY THE WILL COUNTY CLERK'S OFFICE  
302 N. CHICAGO STREET, JOLIET, IL 60432 (815) 740-4613

Disclaimer of Warranties and Accuracy of Data  
Although the data developed by Will County for its maps, websites, and Geographic Information System has been produced and processed from sources believed to be reliable, no warranty, expressed or implied, is made regarding accuracy, adequacy, completeness, legality, reliability or suitability of any information. The disclaimer applies to both printed and electronic versions of the information. The County and elected officials provide this information on an "as is" basis. All warranties of any kind, express or implied, including but not limited to the implied warranties of merchantability, fitness for a particular purpose, freedom from contamination by computer viruses or hackers and non-infringement of proprietary rights are disclaimed. Changes may be periodically made to the information herein, these changes may or may not be incorporated in any new version of the distribution. If you have obtained information from any of the County web pages from a source other than the County pages, be aware that electronic data can be altered subsequent to original distribution. Data can also quickly become out of date. It is recommended that careful attention be paid to the contents of any data, and that the originator of the data or information be contacted with any questions regarding appropriate use. Please direct any questions or issues via email to gis@willcountyilinois.com.