

41-70226N
86-03987W

41-70226N
87-51951W

COOK COUNTY, IL

COOK COUNTY JUDICIAL DISTRICTS

Pursuant to the COOK COUNTY CIRCUIT
APPORTIONMENT ACT OF 1991

DISTRICT 15

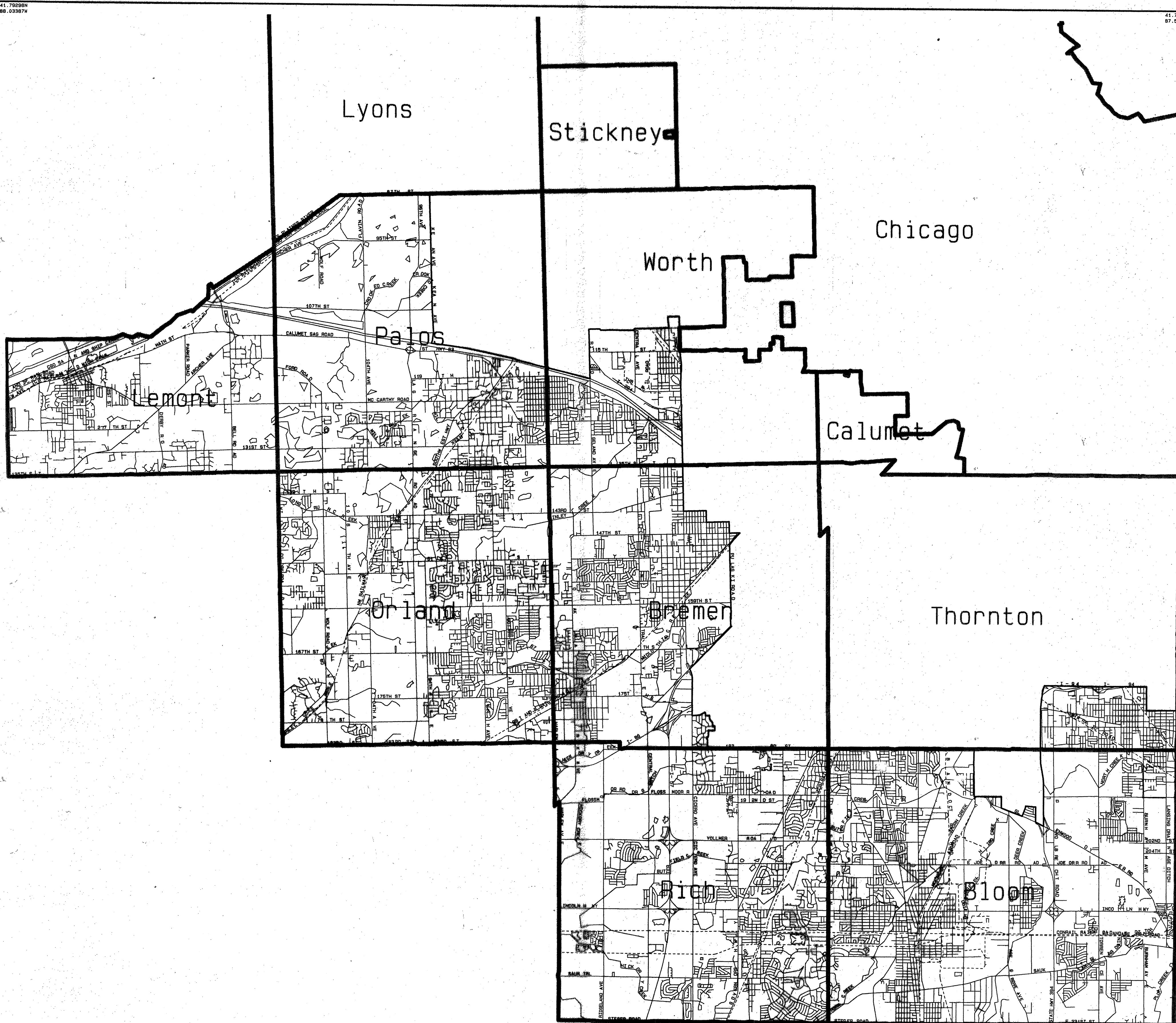

Scale: 1" = 6726'

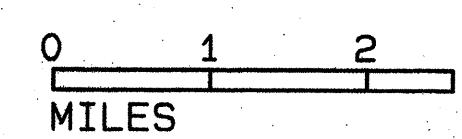

DAVID D. ORR COUNTY CLERK

Produced by Election Data Services
1225 I Street NW, Suite #700
Washington, DC 20005-3954
93/12/20 TIGER*Plot version 03.307

41-40842N
86-03987W

41-40842N
87-51951W

COOK COUNTY JUDICIAL CIRCUIT, SUBCIRCUIT NO. 15

Beginning at the Intersection of the Lyons-Palos Township Line (87th Street as extended) and the Des Plaines River, in Willow Springs,
Thence southwest along the Des Plaines River to the Cook-DuPage County Line,
Thence continuing along the Cook-DuPage County Line southwest (Des Plaines River, in part) and west (111th St. as extended and 111th Street) to the intersection point of Cook, DuPage and Will Counties,
Thence along the Will-Cook County Line as follows: south (Smith Rd. as extended and Smith Rd.), east (135th St. and 135th St. as extended), south (Will-Cook Road and Will-Cook Road as extended), east 183rd Street and 183rd Street as extended, south (Harlem Ave.), east (Steger Rd.), and north (Illinois-Indiana State Line) to Adams Street as extended (in Lansing),
Thence west on Adams Street as extended and Adams Street to Walter Street,
Thence north on Walter Street and Walter Street as extended to I-80,
Thence west on I-80 to State Highway 394,
Thence south on State Highway 394 to Glenwood-Dyer Road,
Thence northwest on Glenwood-Dyer Road to Dante Avenue,
Thence north on Dante Avenue to 192nd Street,
Thence west on 192nd street to Minerva Avenue,
Thence southwest on Minerva Avenue to Glenwood-Dyer Road,
Thence northwest on Glenwood-Dyer Road to Champlain Avenue,
Thence north on Champlain Avenue to Glenwood-Lansing Road,
Thence west on Glenwood-Lansing Road and Glenwood-Lansing Road as extended (the corporate boundary of Glenwood) to the Missouri Pacific R.R.,
Thence north on the Missouri Pacific R.R. to 183rd Street as extended (Thornton-Bloom Township line),
Thence west on 183rd Street as extended and 183rd Street (also known as Arquilla Dr.) to Anthony Avenue,
Thence generally north on Anthony Avenue to 180th Street,
Thence east on 180th Street to Kostner Avenue,
Thence north on Kostner Avenue to 179th Street,
Thence west on 179th Street to Baker Avenue,
Thence generally north on Baker Avenue to 177th Place,
Thence west on 177th Place to Anthony Avenue,

Thence north and northwest on Anthony Avenue to 177th Street,
Thence southwest and west on 177th Street to Cicero Avenue,
Thence north and northwest on Cicero Avenue to I-57,
Thence northeast on I-57 to the corporate boundary of Markham,
Thence north on the corporate boundary of Markham onto Crawford
Avenue,
Thence continuing north on Crawford Avenue to the Chicago, Rock Island
& Pacific R.R.,
Thence northeast on the Chicago, Rock Island & Pacific R.R. to 147th Street,
Thence west on 147th Street to Crawford Avenue,
Thence north on Crawford Avenue to 145th Street,
Thence west on 145th Street to Kostner Avenue,
Thence north on Kostner Avenue to 143rd Street,
Thence west on 143rd Street to Cicero Avenue,
Thence north on Cicero Avenue to 109th Street,
Thence west on 109th Street to Lavergne Avenue,
Thence south on Lavergne Avenue and Lavergne Avenue as extended to
111th Street,
Thence west on 111th Street to Ridgeland Avenue,
Thence south on Ridgeland Avenue to the Calumet-Sag Channel,
Thence northwest along the Calumet-Sag Channel to Kean Avenue,
Thence north on Kean Avenue to 87th Street,
Thence west on 87th Street and 87th Street as extended to the place of
beginning.